

VALLEY BOULEVARD

RAILROAD RIGHT OF WAY - LA PUENTE

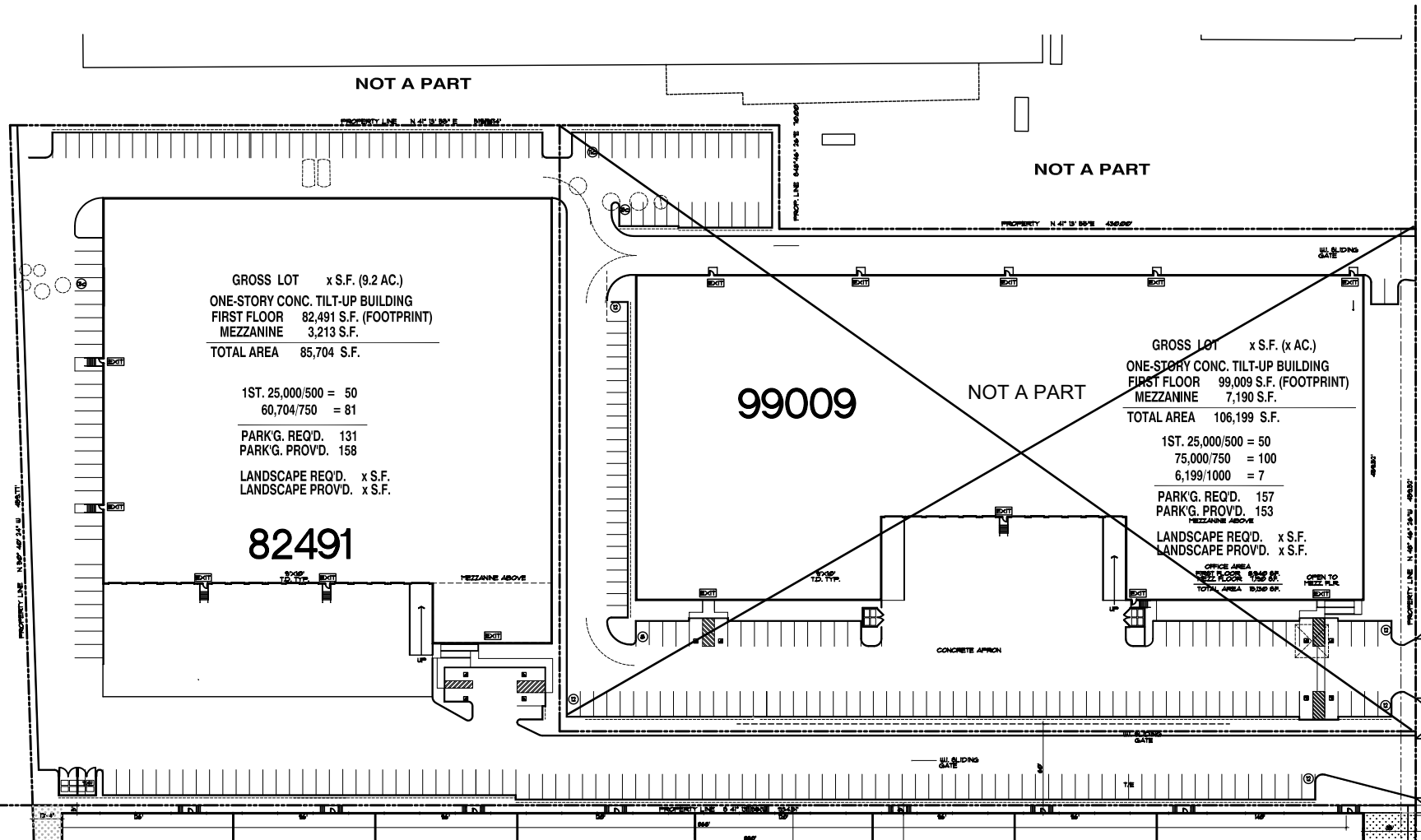

GROSS LOT x S.F. (9.2 AC.)  
ONE-STORY CONC. TILT-UP BUILDING  
FIRST FLOOR 82,491 S.F. (FOOTPRINT)  
MEZZANINE 3,213 S.F.  
TOTAL AREA 85,704 S.F.

1ST. 25,000/500 = 50  
60,704/750 = 81

PARK'G. REQ'D. 131  
PARK'G. PROV'D. 158

LANDSCAPE REQ'D. x S.F.  
LANDSCAPE PROV'D. x S.F.

**82491**

**99009**

GROSS LOT x S.F. (x AC.)  
ONE-STORY CONC. TILT-UP BUILDING  
FIRST FLOOR 99,009 S.F. (FOOTPRINT)  
MEZZANINE 7,190 S.F.  
TOTAL AREA 106,199 S.F.

1ST. 25,000/500 = 50  
75,000/750 = 100  
6,199/1000 = 7

PARK'G. REQ'D. 157  
PARK'G. PROV'D. 153

LANDSCAPE REQ'D. x S.F.  
LANDSCAPE PROV'D. x S.F.

OFFICE AREA  
FIRST FLOOR 4,345 S.F.  
MEZZANINE 2,845 S.F.  
TOTAL AREA 7,190 S.F.

**SITE PLAN**  
SCALE: 1"=50'-0"

